

# UPC-206A

## Modular Industrial PC



### Features

- Intel Baytrail Celeron J1900 2.0-2.4GHz CPU
- Memory up to 8GB DDR3
- 1\*SATA 2.5inch SSD, 1\* mSATA SSD socket
- Wireless Design
- Aluminum Chassis, Fanless Design
- DC 9~36V Wide Power Input

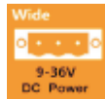

UPC-206A is a compact dimension industrial computer with an Intel® J1900 processor, dual GbE LAN, 3 x COM ports, 6 x USB ports, 1xmSATA bay. DC 9-36V wide power input, wide operating temperature, economic and reliable, it will be fit for IOT terminal and manufacture application.

### Specifications

<b>Processor</b>	CPU	Intel Baytrail-D Celeron J1900, 2.0~2.42GHz, 4cores, 4threads, 2M cache, 22nm,TDP 10W	
	Cooling System	Fanless	
	Memory	Single Socket, 4GB-8GB DDR3L	
	Storage	mSATA SSD Full Size + SATA 2.5 inch SSD	
	I/O ports		5xUSB2.0+1xUSB3.0, Type-A
			COM: 3xRS232, DB9, 2*RS485 optional
			Dual Display: 1xHDMI (1920*1200 @30Hz) 1xVGA (1920*1200 @30Hz)
			Audio: 1xMic-in, 1x Line-out
Network(LAN)	2x Intel I211 10/100/1000Mbps Ethernet		
<b>Power Supply</b>	Input Voltage	12V DC (3 Pin Phoenix Connector) , optional 9V-36V DC	
	<b>Control SW</b>	Control SW	
<b>OS Support</b>	OS Support	Windows 7, Windows 8.1, Windows 10, Linux Ubuntu	
<b>Environment</b>	Operating Temperature	0°C ~ 50°C (extend temperature optional)	
	Storage Temperature	-10°C ~ 60°C (extend temperature optional)	
<b>Mechanical</b>	Dimensions	(W*D*H): 195*158*42.8mm With Bracket: 229*160*46mm	
	Weight(G.W.)	N.W. 1.7KG	
	Color	Black	
	Material	High Strength Aluminum Alloy	
	Certification	CE / UL / RoHS	



**Dimensions**

Unit: mm

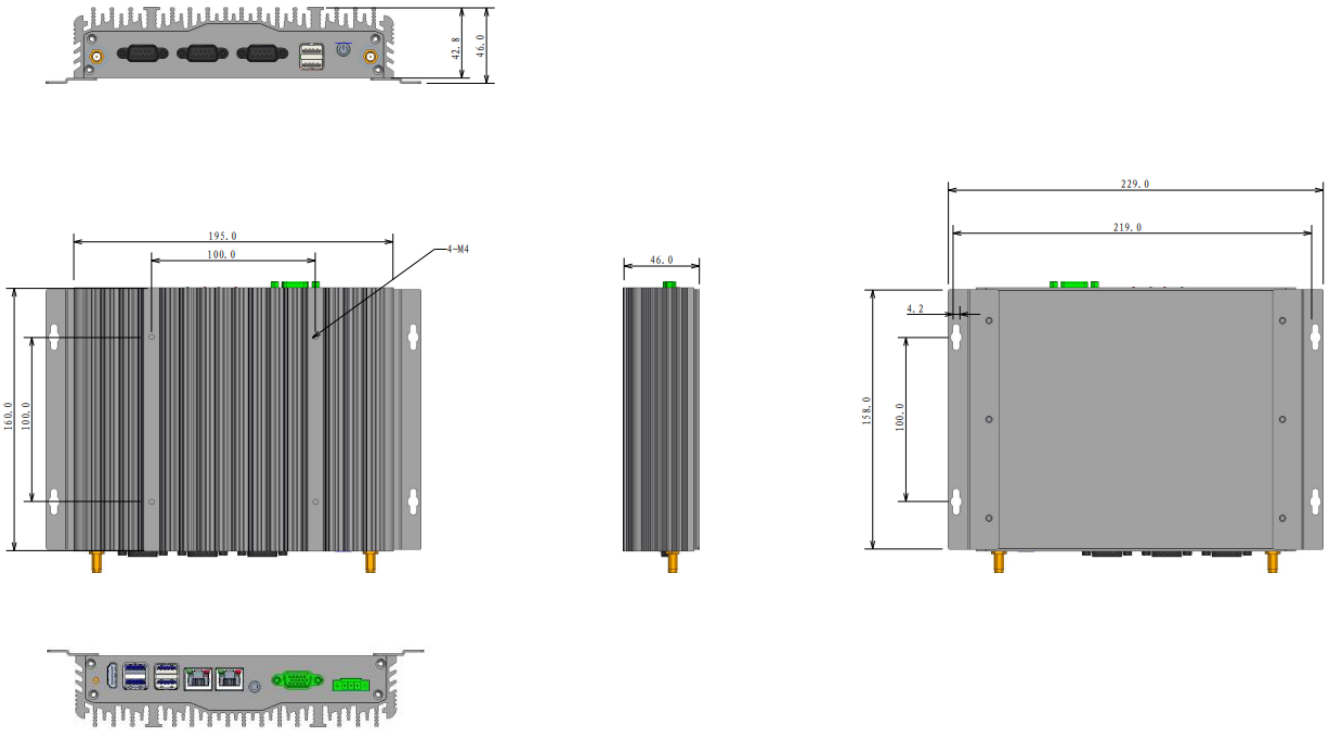

Packing List	Ordering Information
1x UPC-206A	UPC-206A-1: J1900 Version
1x Driver CD	Operating Systems
1x Power Adapter	WIN7 32bit 64bit ENG
Optional accessories	WIN8 32bit 64bit ENG
Brackets	WIN10 32bit 64bit ENG
Power Cable 2-pin 200cm	<b>Ps:</b> Default BIOS supports WIN7 32bit 64bit OS, WIN 8 & WIN 10 needs update BIOS.